

# THE Blackridge CIVIC ASSOCIATION INC.

## CLUBHOUSE RENTAL INFORMATION



### BCA HISTORY

The Blackridge Civic Association as it roots in a time-honored American Tradition: a mini-tax revolt.

By 1944, the new community of Blackridge was losing some of the rawness of its earliest years. Through the efforts of the five-year-old Garden Club, trees now lined the streets, work was ready to start on the corner plantings, and funds were raised for handsome new road markers. The years of hard work resulted in an attractive and prestigious residential community - leading to an unwelcome jolt of a substantial increase in property taxes.

The ladies of the Garden Club took action by circulating a petition claiming that tax penalties were being levied because of individual and collective improvements. When the petition produced no practical results, the civic committee of the Club called a meeting on Sunday afternoon in 1944 and invited their husbands to join in the effort to reduce the new assessments. That afternoon, the Blackridge Civic Association was launched and with it a new era in Blackridge history.

Today, the Blackridge Civic Association seeks to provide community identity for the neighborhood that now includes parts of Wilkesburg, Churchill and Penn Hills.

The Civic Association built its Clubhouse through community support in 1953 and opened the swimming pool as an independent subsidiary in 1972. Property includes approximately ten acres of wooded land, ball fields, and a playground. A full social program for adults and children has evolved over the years along with the regular publication of a community newsletter.

### IMPORTANT INFORMATION

- Friday, Saturday and Sunday rentals may access building at 7:00 a.m. on the day of your event.
- The building must be vacated by 11:00 pm Friday and Saturday, 10:00 p.m. Sunday. NO EXCEPTIONS.
- Kitchen accessories, including dishes, utensils, table linens, glassware, etc., are NOT available.
- Rooms must be left in good order and the condition in which they were found. Charges will be assessed for any damages caused by the renter and guests of the renter.
- Service of alcoholic beverages is permitted within the building. Sales of alcoholic beverages (i.e. "cash bars") are NOT permitted.
- No tacks, tape, nails, staples or other fasteners may be used on the walls or ceiling in decorating for your event.
- The use of the Blackridge pool is NOT included in rental.
- Security is NOT provided.
- No pets allowed on the premises.
- CREDIT CARDS OR MONEY ORDERS ONLY. NO CASH OR PERSONAL CHECKS.
- The Clubhouse is wholly operated and maintained by volunteer residents of Blackridge.

**The clubhouse is a non-smoking facility.**  
Smoking permitted only in designated outside areas.

1200 Beulah Road  
Churchill, PA 15235

THE Blackridge  
CIVIC ASSOCIATION INC.

Volunteer Rental Director  
[rentals@blackridge-bca.org](mailto:rentals@blackridge-bca.org)



is the perfect location for wedding

receptions, showers, parties, meetings, family gatherings and special events. The clubhouse is situated on wooded, landscaped grounds and conveniently located in Churchill just off the Parkway East, approximately 10 miles from downtown Pittsburgh. The facility can accommodate up to 180 people.

DRIVEWAY

**CLUBHOUSE LAYOUT**

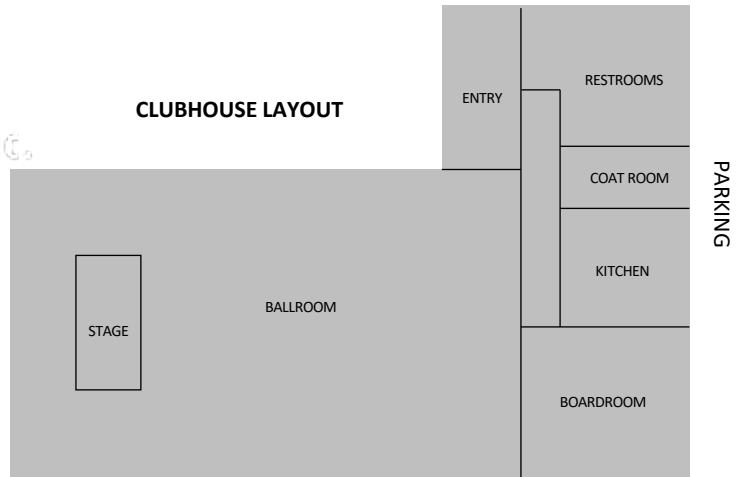

**Visit the Clubhouse Rentals page at [www.blackridge-bca.org](http://www.blackridge-bca.org)  
For availability and more information**

Rental Fee Rates	Friday – Sunday Event Rate	Monday – Thursday Meeting Rate
*Current Member Rate	\$295	\$15/Hour 4 hour minimum
**New Member Rate	\$395	\$15/Hour 4 hour minimum
Non-Member Rate	\$495	\$25/Hour 4 hour minimum

**BCA CLUBHOUSE FEATURES**

- BALLROOM  
40' x 70' – SEATING FOR 150  
20 - 8' TABLES AND METAL FOLDING CHAIRS INCLUDED
- 
- SMALL RAISED STAGE  
12' x 24'
- 
- BOARD ROOM  
20' x 20' – SEATING FOR 30  
20 - 8' TABLES AND METAL FOLDING CHAIRS INCLUDED
- 
- PORTABLE BAR STAND
- 
- FULL KITCHEN  
6 - burner industrial stove, household refrigerator, microwave, 2 sinks, stainless countertops and prep areas
- FOOD STORAGE AND RE-HEATING ONLY  
ABSOLUTELY NO COOKING**
- 
- AIR CONDITIONING
- 
- ON-SITE PARKING FOR 54 CARS

\* Must be a member in good standing for at least one year.  
\*\* Discounted rate when enrolling as a new member.

**TO GUARANTEE A DATE**

An initial deposit of \$100 must be paid by credit card or money order with the signed contract to guarantee your date. A damage deposit of \$500.00 is due one month prior to the event, and the balance due must be paid two weeks prior to the event. Two weeks after the event the \$500 damage deposit will be refunded provided there is no damage and all rules of the rental contract are followed. A 90 day written notice of cancellation is required to receive a full refund.

**Less than 90 days notice will result in forfeiture of the damage deposit.**

**DIRECTIONS**

**From 376E** take exit 79B (Churchill). Turn right on Churchill Road, right onto Beulah Road, cross Wm. Penn Highway and take the second left to the BCA Clubhouse.

**From 376W** take exit 79B (Churchill). Turn right at light onto Beulah Road and take the second left to the BCA Clubhouse.

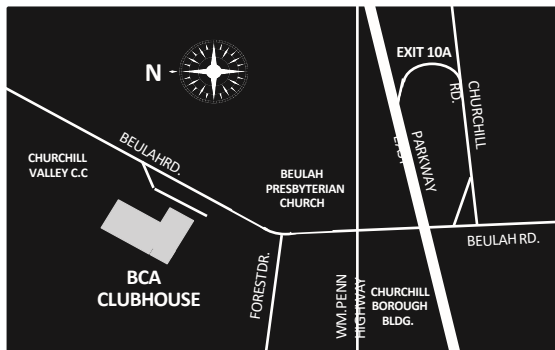

1200 Beulah Road  
Churchill, PA 15235



Volunteer Rental Director  
[rentals@blackridge-bca.org](mailto:rentals@blackridge-bca.org)